

**KUKA**

**The press-to-press robot  
for the high payload category**



**Series 2000  
KR 100-2 P,  
KR 120-2 P**

## »THE KUKA PRESS-TO-PRESS ROBOTS: MASTERS OF HIGH-SPEED PRESS LINKING

A long reach and a wide range of payloads – these are the strengths of the KUKA press-to-press robots: whether they're bridging short press gaps or transferring large or medium-sized panels, thanks to their modular design and our long experience of press linking, we can optimally tailor your robot to the individual application.

And as if that were not enough, the robust design with low-wear components – such as beltless wrist drives – prolongs the service life and extends the maintenance intervals – thereby reducing your costs. The result is robots that not only set new standards in the market but also make your production more cost-effective.

**The advantages: high planning reliability and security of investment.**

### »EXTREMELY FAST – EXTREMELY PROCESS-OPTIMIZED

More speed and maximum output: their lightweight construction of die-cast aluminum makes the press-to-press robots exceptionally fast. With a specially adapted drive train and machine data, they achieve a high throughput of up to 14 parts per minute – across a press gap of 6 m. Added to this is the precision control, which results in a repeatability of up to  $\pm 0.06$  mm.

**The advantages: increased output and fewer rejects.**

### »EXTREMELY POWERFUL – EXTREMELY RELIABLE

Powerful motors, gear units and servo drives – our press-to-press robots give you guaranteed high quality, because they are assembled using service-proven standard components from the 2000 Series. This means that your robot is not just optimally tailored to its application; you also benefit from fast availability of tried-and-tested components, a wide variety of models and extended maintenance intervals. **The advantages: optimal production and rapid commissioning.**

## »TECHNICAL DETAILS 100-2 P AND KR 120-2 P

Dimensions: mm

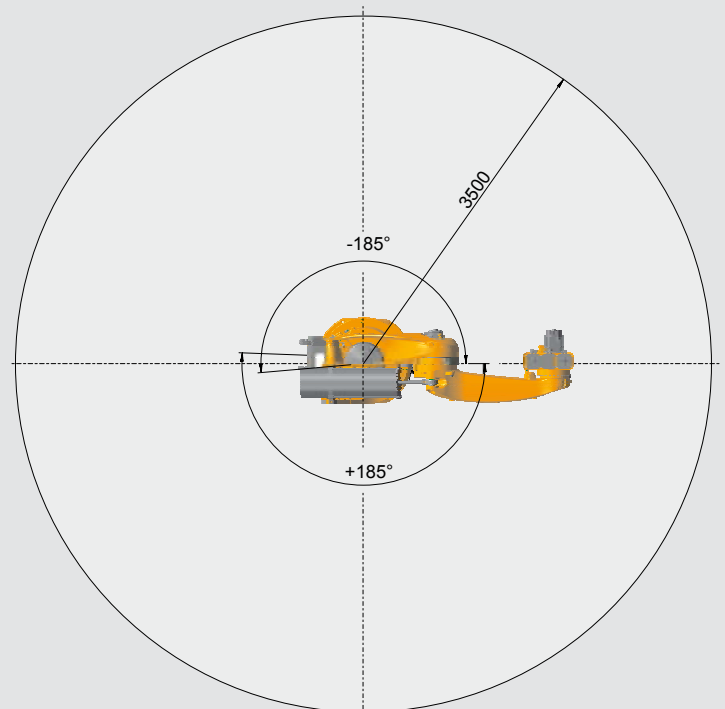
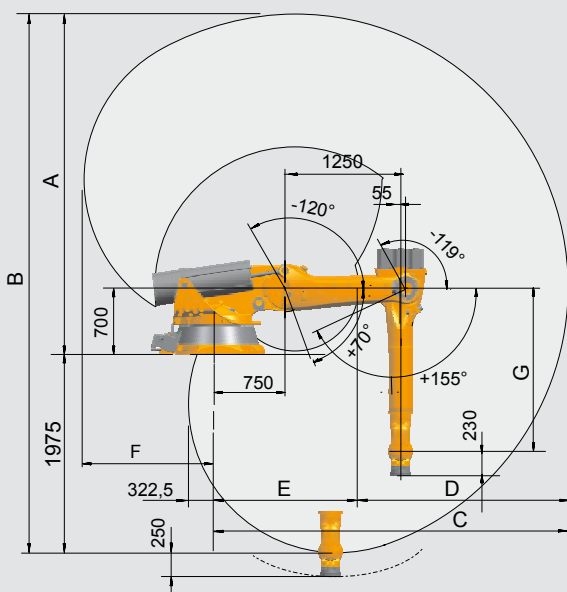

Work envelope	Dimensions							Volume
	A	B	C	D	E	F	G	
KR 100-2 P	3,450 mm	5,425 mm	3,500 mm	2,108 mm	1,392 mm	1,376 mm	1,500 mm	145.0 m <sup>3</sup>
KR 120-2 P	3,450 mm	5,425 mm	3,500 mm	2,108 mm	1,392 mm	1,376 mm	1,500 mm	145.0 m <sup>3</sup>

**»EXTREMELY COST-EFFECTIVE – EXTREMELY PRECISE**

Automatically better: with a KUKA robot you not only have all process steps under control, but also benefit from top performance and flexibility. Thanks to pioneering robotics and control technology, you can rely around the clock on maximum precision – as well as on ease of operation, simple space-saving integration into production sequences, and availability rates of almost 100%. **The advantages: production with greater precision and lower costs.**

**»EXTREMELY VERSATILE – EXTREMELY SAFE**

KUKA offers you a comprehensive range of software. In addition to system software and simulation programs for system design, we also provide you with specific application software, such as KUKA.PresTech: the software coordinates and optimizes, among other tasks, the motion sequences of the robots and presses – for collision-free cooperation and optimized output. **The advantages: maximum ease of operation and major time savings.**

Type	KR 100-2 P	KR 120-2 P
Maximum reach	3,500 mm	
Rated payload	100 kg	120 kg
Suppl. load, arm/link arm/rotating col.	50/50/50 kg	
Suppl. load, arm + link arm, max.	50 kg	
Maximum total load	150 kg	170 kg
Number of axes	6	
Mounting position	Shelf-mounted, floor, ceiling	
Variant		
Positioning repeatability*	±0.06 mm	
Path repeatability*		
Controller	KR C2 edition2005	
Weight (excluding controller), approx.	1,465 kg	
Temperature during operation	+10 °C to +55 °C	
Protection classification	IP 65	
Robot footprint	1,230 mm x 1,230 mm	
Connection	13.5 kVA	
Noise level	< 75 dB	

Axis data	Range (software)	Speed with rated payload	
		100 kg	120 kg
Axis 1 (A1)	±185°	102°/s	102°/s
Axis 2 (A2)	+70°/-120°	96°/s	96°/s
Axis 3 (A3)	+155°/-119°	95°/s	83°/s
Axis 4 (A4)	±350°	185°/s	121°/s
Axis 5 (A5)	±125°	190°/s	124°/s
Axis 6 (A6)	±350°	238°/s	184°/s

Drive system, electromechanical with brushless AC servomotors

\*to ISO 9283

Details provided about the properties and usability of the products are purely for information purposes and do not constitute a guarantee of these characteristics. The extent of goods delivered and services performed is determined by the subject matter of the specific contract. No liability accepted for errors or omissions.



## »THE KUKA ROBOT GROUP: YOUR STRONG PARTNER

Quality made in Germany, creativity and the utmost commitment to customers and business partners: these form the basis on which KUKA develops the best possible technologies and thus the optimal automation concepts. The result is that you receive custom-tailored solutions and benefit from decisive process optimization.

Genuine passion for the fascination of robotics is reflected in our slogan “KUKA YOUR IDEAS”, which is also our promise to you: Whatever you want to do, and however unusual your idea may be, with us you can implement anything – irrespective of the specific branch of industry and irrespective of whether or not a similar application has existed before.

Whatever task you give us, KUKA has the required specialists. In close cooperation with experienced system partners with competence in their respective industries, we do everything in our power to implement your ideas. Let us work on them together.

## »KUKA SERVICES: ALWAYS THERE FOR YOU

You can rely on us to stand by you in every phase of a project: from planning and commissioning to maintenance and conversion. 24 hours a day. 365 days a year. The high-density KUKA service network ensures that we are always in your vicinity and can start your production in record time.

# KUKA YOUR IDEAS

## KUKA ROBOTER GMBH

Global Sales Center  
Hery-Park 3000  
86368 Gersthofen  
Germany  
Tel. +49 821 4533-0  
Fax +49 821 4533-1616  
info@kuka-roboter.de

Additional contact addresses:  
[www.kuka-robotics.com](http://www.kuka-robotics.com)